

Development Site on Intersection at Interstate Exit State Routes 7 and 30A, Schoharie, NY

For Sale: \$680,000

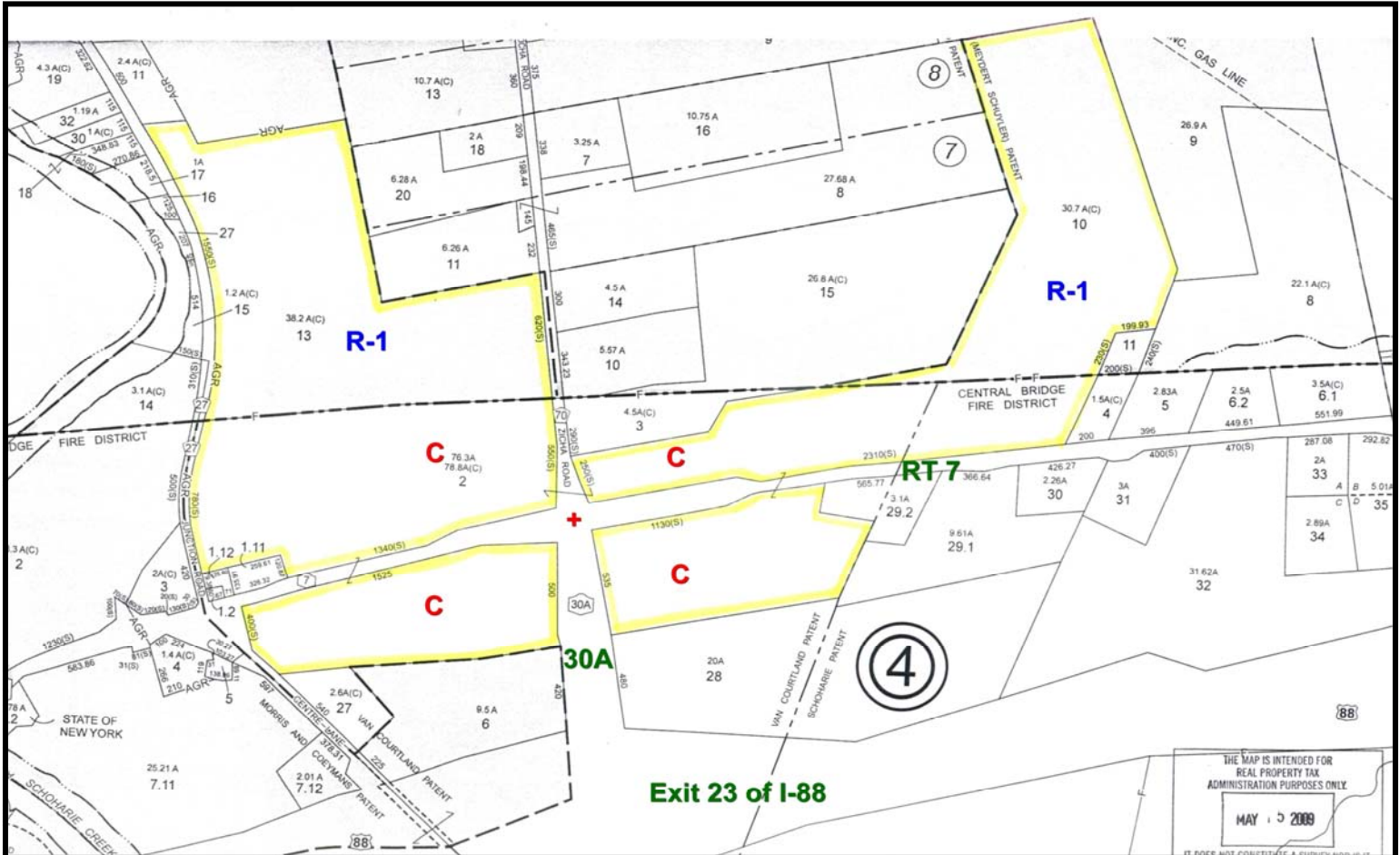

Site Profile

0 State Route 7 (and 30A, Schoharie NY)

Acreage: 147.7 on Signaled Intersection off Exit 23, I-88

Frontage: 11490 ft

Zoning: Commercial on all 4 Corners at Intersection
R-1 Residential on Northern Acreage Currently

Other: 30 Miles to Albany, Rural Setting with Valley Views

Appraised at \$1,050,000 (Feb. 2009)

NAI Platform

Commercial Real Estate Services, Worldwide.

The information contained herein has been given to us by the owner of the property or other sources we deem reliable, we have no reason to doubt its accuracy, but we do not guarantee it. All information should be verified prior to purchase or lease.

Contact information:

Richard Rackowski

Mobile: 239.898.0304

(518) 465-1400 ext. 205

RickRackRealty@aol.com